

## BOTTOM BRACKET - STAINLESS STEEL AND CERAMIC

### COMPATIBILITY:

Hope Bottom brackets work with any cranks which are compatible with Shimano Hollowtech II and Race Face X-Type.

### 1/FRAME PREPARATION:

It is critical to bearing life that the frame is prepared correctly. Chase threads and face ends of BB shell to ensure they are clean and square.

### 2/INSTALL BB CUPS:

Remove Non-Drive cup from pre-assembled BB. Determine spacers required (see below). Apply copious amounts of grease to the BB cups and the frame BB shell. Thread Drive-Side BB cup with centre tube and appropriate spacers (see below) anti-clockwise into RH side of frame using correct spanner and tighten.

Thread Non-Drive BB cup and appropriate spacers (if required) clockwise into LH side of frame and tighten.

### 3/INSTALL CRANKS:

Follow manufacturer's instructions.

**Note:** Hope BB's allow cranks to fit directly in the bearing inner race, not through a plastic bush

Hope Technology  
Fernbank Avenue  
Barnoldswick  
BB18 5UY  
United Kingdom  
Tel: +44 (0)1282 851200  
Fax: + 44 (0)1282 851201

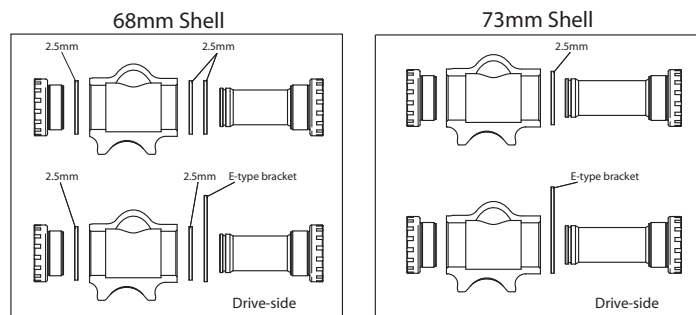

[www.hopetech.com](http://www.hopetech.com)

## BOTTOM BRACKET - STAINLESS STEEL AND CERAMIC

Issue: 1  
Jan 2008

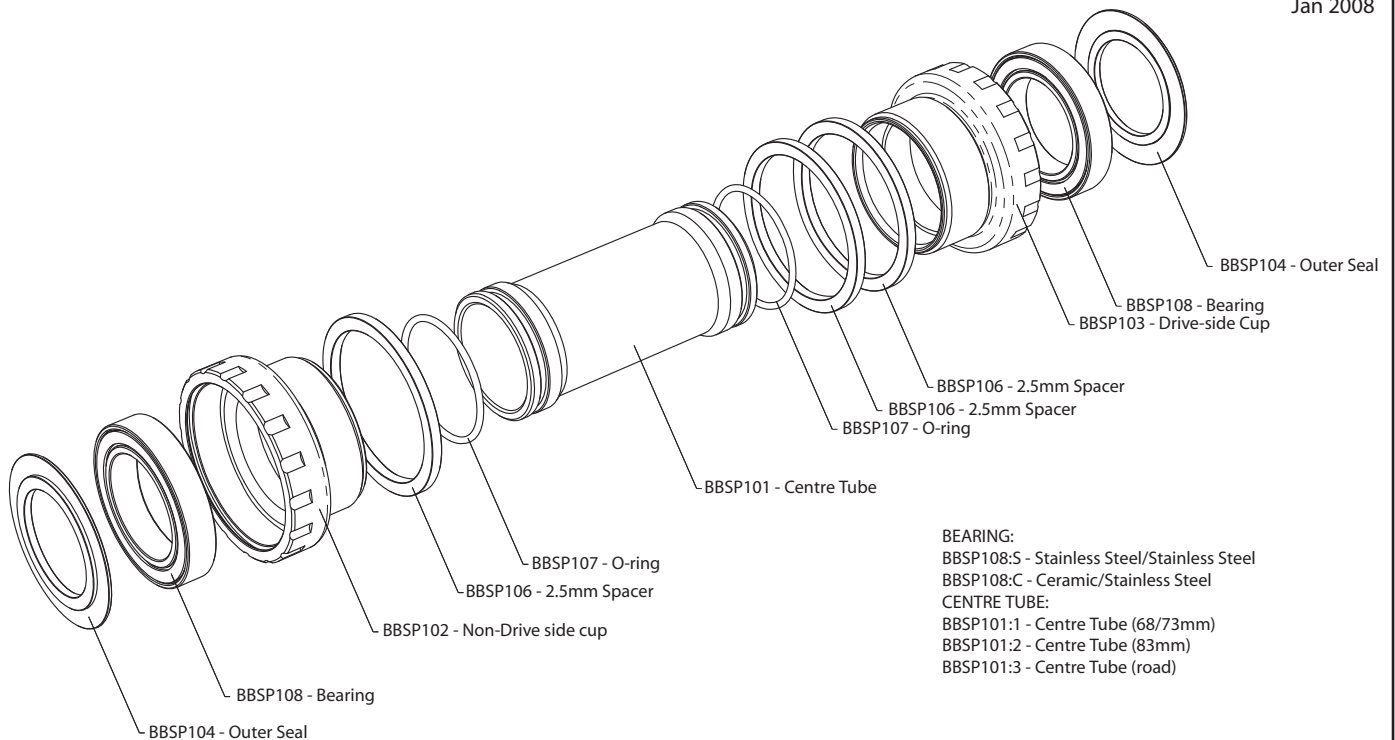

[www.hopetech.com](http://www.hopetech.com)

